

注: 本图禁止传输、复制、编辑、修改, 以及用其内容建设数据库

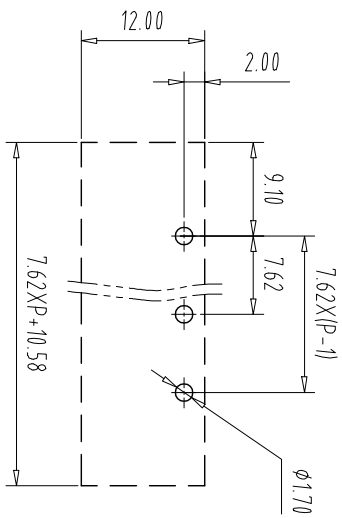
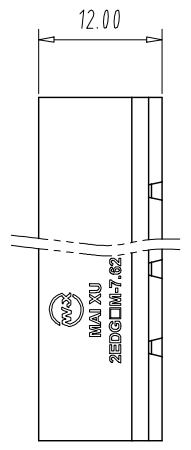
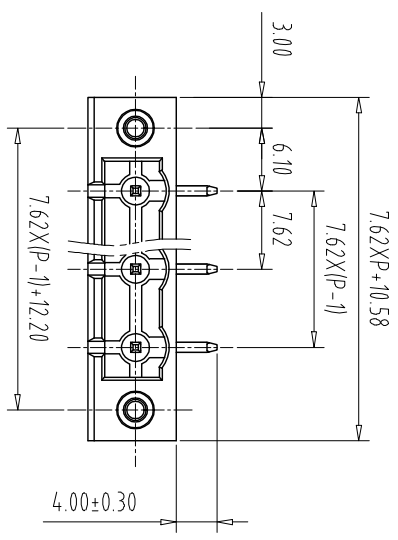

PCB Layout

Pitch Range In mm		Nominal Dimension Range In mm		Nominal Dimension Range	
Over 6	Over 10	Over 30	Over 60	Over 100	Over 150
TO 6	TO 10	TO 24	TO 30	TO 60	TO 100
±0.15	±0.20	±0.30	±0.30	±0.50	±0.70
				±1.00	±1.30
					±2°

REV	ECN NO.	CONTENT	CHK	DATE

NOTES1:
UL Standard

1	Use group	B	C	D
	Rated Current	15A	/	10A
	Rated Voltage	300V	/	300V

2. withstanding voltage: AC1600V/1min
IEC Standard

1	Pollution Degree	3	2	2
	Overvoltage Category	III	III	II
	Rate Impulse Voltage(kV)	/	4.0kV	/
	Rate Voltage(V)	/	400V	/
	Rate Current(A)	/	15A	/

NOTES2:

- 1.Housing: PA66 (UL94V-0)
- 2.Solder Pin: Brass (Sn Plated)
- 3.Nut: Brass (M2.5)

NOTES3:

- 1.Pitch: 7.62mm Poles: 02-24P
- 2.Operating temperature: -40°C~+105°C
- 3.RoHS Compliance

How to order

MX2EDGRM - 7.62 - XXP - XXXX - X - X

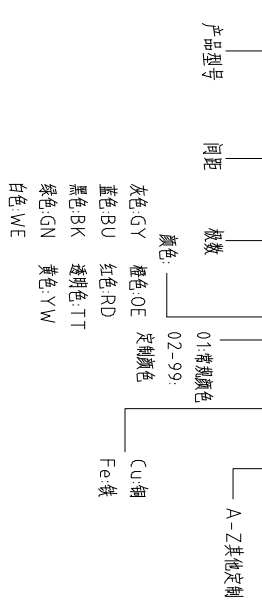

ITEM	NAME OF PART	NO. OF PART	Q'TY	MATERIAL	NOTE
DWG.	CHK	DATE	UNITS	MM	1/1
APP.	DATE	SCALE	A4	1:1	1/1
CIXI MAIXU ELECTRONICS CO.,LTD.				NAME	MX2EDGRM-7.62-XXP
MAIXU 慈溪市迈旭电子有限公司				DWGNO.	