

注: 本资料禁止传输、复制、编辑或修改, 以及用其内容进行标注

| REV | ECN NO. | CONTENT | CHK | DATE |
|-----|---------|---------|-----|------|
| | | | | |

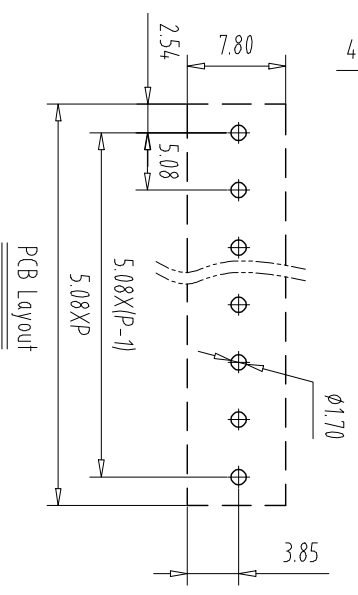
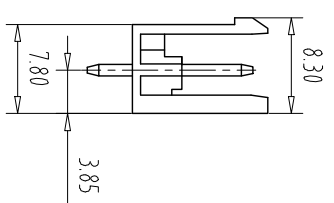
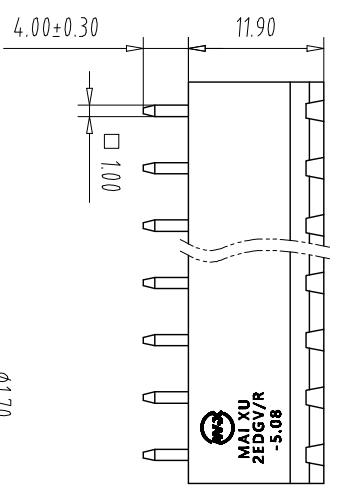
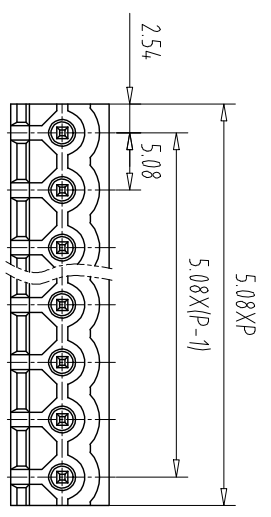

NOTES1:

- 1. UL Standard
- 1. Rating voltage/current: 300V/15A
- 2. withstanding voltage: AC2000V/1Min
- IEC Standard

| | |
|--------------------------|-------|
| 1. Pollution Degree | 2 |
| Overvoltage Category | III |
| Rate Impulse Voltage(KV) | 4.0KV |
| Rate Voltage(V) | 320V |
| Rate Current(A) | 15A |

NOTES2:

- 1. Housing: PA66 (UL94V-0)
- 2. Solder Pin: Brass (Sn Plated)

NOTES3:

- 1. Pitch: 5.08mm Poles: 02-24P
- 2. Operating temperature: -40°C ~ +105°C
- 3. RoHS Compliance

How to order

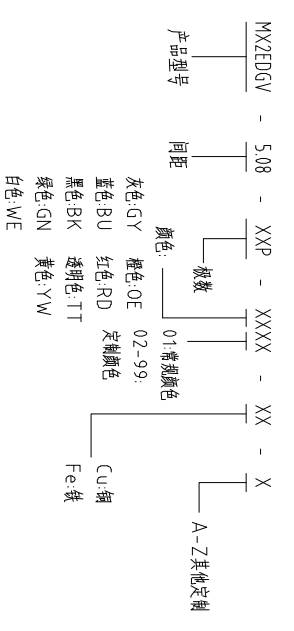

| Pitch Range In mm | | Nominal Dimension Range In mm | | Nominal Dimension Range | | Tolerance | |
|-------------------|---------|-------------------------------|---------|-------------------------|----------|-----------|--------|
| Over 6 | Over 10 | Over 10 | Over 30 | Over 60 | Over 100 | Over 150 | 0.1/10 |
| TO 6 | TO 10 | TO 24 | TO 30 | TO 60 | TO 100 | TO 150 | ±2° |
| ±0.15 | ±0.20 | ±0.30 | ±0.30 | ±0.50 | ±0.70 | ±1.00 | ±1.30 |

| ITEM | NAME OF PART | NO. OF PART | Q'TY | MATERIAL | NOTE |
|------|--------------|-------------|-------|------------------|------|
| DWG. | CHK | DATE | UNITS | MM | 1/1 |
| CHK | DATE | SCALE | SCALE | 1:1 | A4 |
| APP. | DATE | NAME | NAME | MX2EDGV-5.08-XXP | |

DATE: 22.09.14

SCALE: 1:1

NAME: MX2EDGV-5.08-XXP

DATE: 22.09.14

SCALE: 1:1

NAME: MX2EDGV-5.08-XXP

MAIXU 慈溪市迈旭电子有限公司

MAIXU ELECTRONICS CO.,LTD.